

P.T.Rail™ Floor Mast

Toilet Support Rail Floor Mast

Technical Data Sheet

Product Specification

The grab rail floor support mast shall be specifically designed for the HealthCraft PT Rail. The product shall be compatible with either a fold up grab rail or a fixed grab rail. The product shall allow the top of the grab rail to be mounted at a height ranging from 31"/78.7 cm to 36"/91.4 cm. The total height of the product shall be 39"/99.1 cm. The base plate of the product shall be 0.25"/0.64cm thick and have 5 fastener holes. The product shall have a weight capacity of 400 lbs/181 kg. The grab rail floor support mast shall be HealthCraft Products model PT-WRM-____ (see table below for appropriate product code).



Key Features

- Compatible with Both Fixed and Folding Rails
- Flexible Mounting Height
- Solid Construction
- 400bs / 181kg Weight Capacity

Codes and Standards

- ADA Compliant Structural Strength (ADAAG 4.26.3)

Specified Model

Model	Finish	Material
PT-WRM-CRP	Triple Chrome Plate	Steel
PT-WRM-PCW	Powder Coat White	
PT-WRM-SS	Stainless Steel	Stainless Steel

P.T.Rail™ Floor Mast

Toilet Support Rail Floor Mast

HEALTHCRAFT
Embrace life.

Technical Data Sheet

Product Dimensions

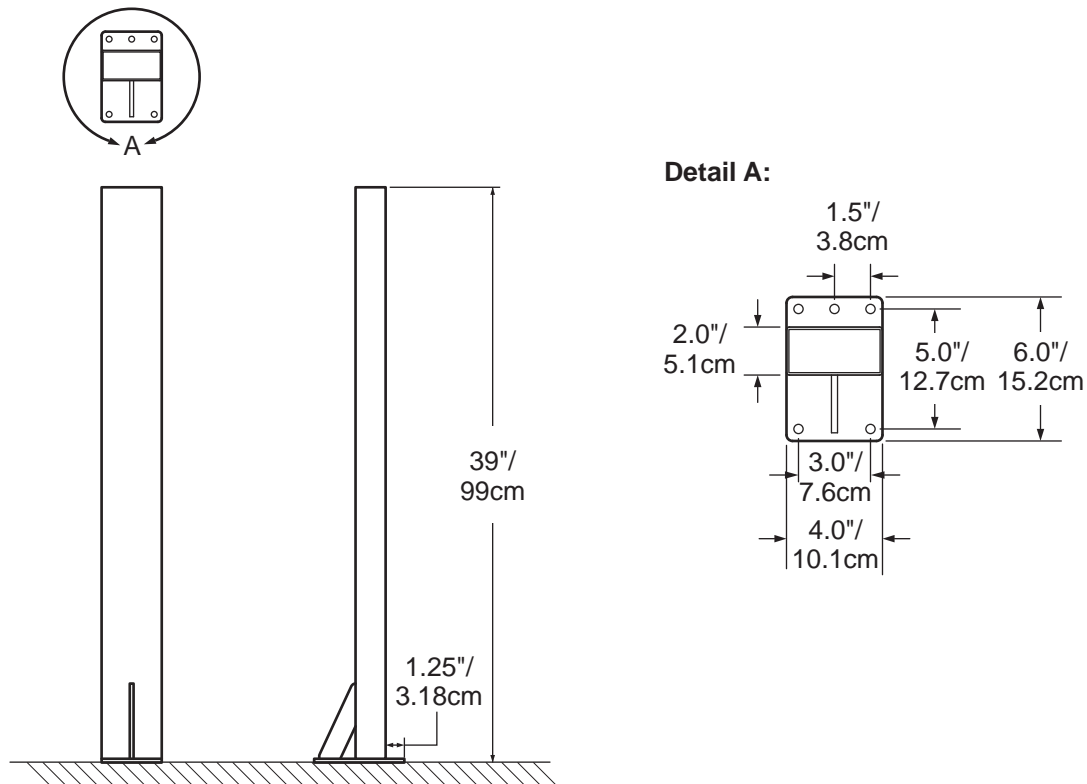

Model	Height (H)	Width (W)	Depth (D)	Weight
PT-WRM	6" / 15.2cm	39" / 99.1cm	7" / 17.8cm	22lbs / 10.0kg

